



Search By Part number

Check stock by region

GO

GO

[PRODUCTS](#)

[CUSTOM CAPABILITIES](#)

[PART BUILDER](#)

[GLOBAL DISTRIBUTION](#)

[ORDER ONLINE](#)

Hex & Round Standoffs

8-32 Threads - .250 [6,35] O.D. - Brass • Aluminum • Stainless Steel

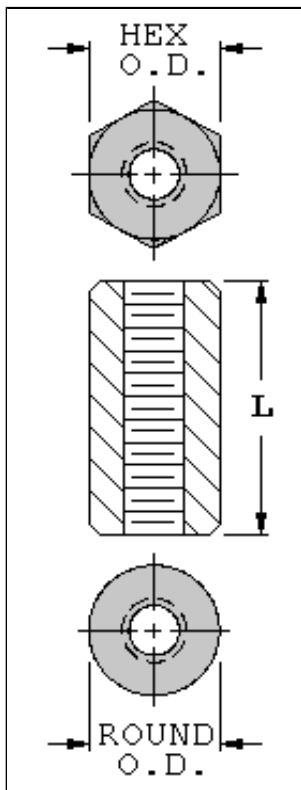

8-32 Threaded Standoffs - .250 [6,35] O.D.						
Length "L" Inch [mm]	O.D. Inch [mm]	Aluminum Clear Iridite		Brass Zinc Plate		Stainless Steel
		Cat. No.		Cat. No.		Cat. No.
		Hex	Round	Hex	Round	Hex
.250 [6,35]	.250 [6,35]	2215	3492	1474A	1692A	1923
.375 [9,53]	.250 [6,35]	2216	3493	1474B	1692B	1923A
.500 [12,70]	.250 [6,35]	2217	3494	1474C	1692C	1923B
.625 [15,87]	.250 [6,35]	1827	1858	1834	1887	—
.750 [19,05]	.250 [6,35]	2218	3495	1474D	1692D	1923C
.875 [22,23]	.250 [6,35]	1828	1859	1836	1888	—
1.000 [25,40]	.250 [6,35]	2219	3496	1474E	1692E	1923D
1.500 [38,10]	.250 [6,35]	2220	3497	1837	1889	1923E
2.000 [50,80]	.250 [6,35]	2221	3498	1838	1889	1923F

Standoffs over 1.000 [25,40] long are tapped .375 [9.63] each end.

Standoff sizes not shown are available on special order.

[Click to Request Samples](#)

[VIEW PRODUCT OVERVIEW](#)

8-32 Threads - .375 [9,53] O.D. - Brass • Aluminum • Stainless Steel

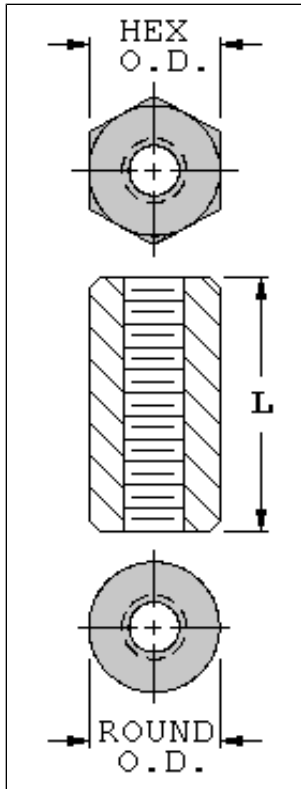

8-32 Threaded Standoffs - .375 [9,53] O.D.						
Length "L" Inch [mm]	O.D. Inch [mm]	Aluminum Clear Iridite		Brass Zinc Plate		Stainless Steel
		Cat. No.		Cat. No.		Cat. No.
		Hex	Round	Hex	Round	Hex
.375 [9,53]	.375 [9,53]	1926A	2315A	1452A	1549A	—
.500 [12,70]	.375 [9,53]	1926B	2315B	1452B	1549B	—
.625 [15,87]	.375 [9,53]	1926C	2315C	1452C	1549C	—
.750 [19,05]	.375 [9,53]	1926D	2315D	1452D	1549D	—
1.000 [25,40]	.375 [9,53]	1926E	2315E	1452E	1549E	—

Standoff sizes not shown are available on special order.

[Click to Request Samples](#)

[VIEW PRODUCT OVERVIEW](#)

© 2005 Keystone Electronics Corp. | 31-07 20th Road | Astoria, NY 11105 | 718-956-8900 | 800-221-5510 | 718-956-9040
 fax | www.keyelco.com